

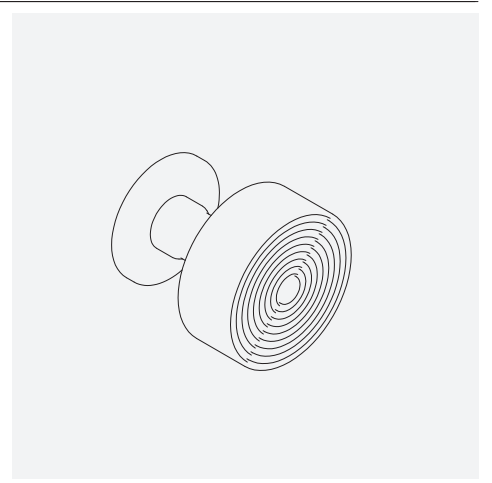

Dana Doorknob

CODE	PROJECTION	LENGTH
DK.001	68mm [2.66 in]	65mm [2.56 in]

The Dana collection is a striking design featuring a reeded motif in the shape of perfectly aligned concentric circles. When designing this piece, we looked back at historical architecture and came across often circular designs. In view of paying homage to traditional ironmongery, the Dana collection was born. Made from the finest grade of solid brass, all pieces are then carefully hand finished in all the standard Björn Collection finishes.

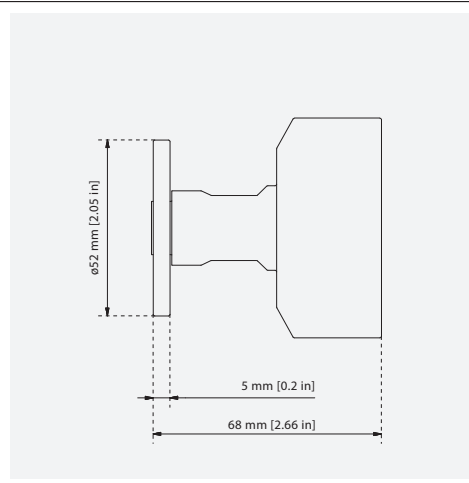
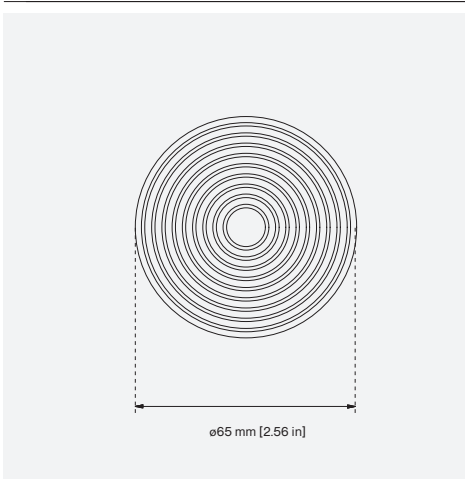

Please note this drawing is the confidential property of Björn Collection and must not be copied or disclosed to any third party without written permission.